

## KWV-614 Large Digital Wind Vane/Anemometer

The KWV-614 comprises a propeller-type wind speed and direction sensor and a large digital display unit. The easy-to-read digital display can be set to display instantaneous or average wind speeds. The KWV-614 has an external output of 0 to 10 mV (or 0 to 1 V).



### SPECIFICATIONS

#### Sensor

Wind speed	Propeller: 4-pole brushless AC generator
Wind direction	Vane: potentiometer ( $5k\Omega \times 2$ )
Startup threshold	$<2$ m/s
Weatherability	Winds $\geq 90$ m/s
Speed output	45 V AC $\pm 1V$ at winds of 60 m/s

#### Display

Wind speed	Measurement range: 2 to 60 m/s Switch to select instantaneous or average wind speed Display method: Red LED, three 7-segment characters, text size 25.4 mm Light-up hold time: Approx. 1 s
Wind direction	Measurement range: 16 cardinal points (inst. only) Display method: Red LED, 16 cardinal point dial, text size 13 mm, indicator always lit up but brightens with change in direction Light-up hold time: Approx. 1 s
Wind speed output	Instantaneous output: 0 to 10 mV DC (0-60 m/s) 10-min. average output: 0 to 10 mV DC (0-60 m/s) Output impedance: $500\Omega$ or less
Wind dir. output	Instantaneous output: 0 to 10 mV DC (0-540°) 10-min. average output: 0 to 10 mV DC (0-540°) Output impedance: $500\Omega$ or less
Housing	Steel, flush-mounted panel type
Power source	100 V AC $\pm 10\%$
Power consumption	Approx. 14 VA

### Sensor dimensions

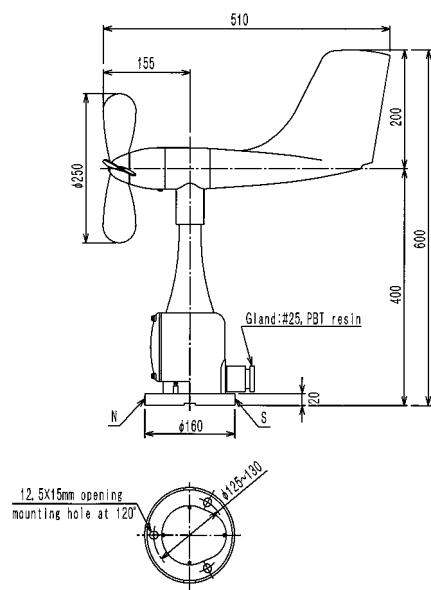

### Digital display dimensions

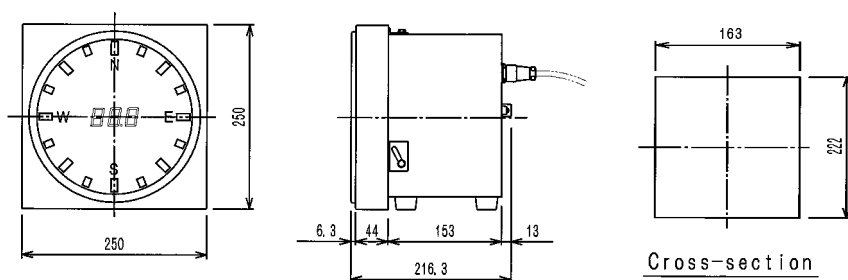

KOMATSU FACTORY CO.,LTD.

WEATHER INSTRUMENTS FABRICATION

1-12-13 Higashiyama Meguro-ku Tokyo 153-0043 Japan

TEL : 03-3719-7131

FAX : 03-3719-7134

e-mail : [info@komatsuins.co.jp](mailto:info@komatsuins.co.jp)